

# LED Light Sword Tutorial

## Items:

- Scotch Tape
- LED  
([Suggested Product](#))
- Straw
- CR2032 Battery  
([Suggested Product](#))

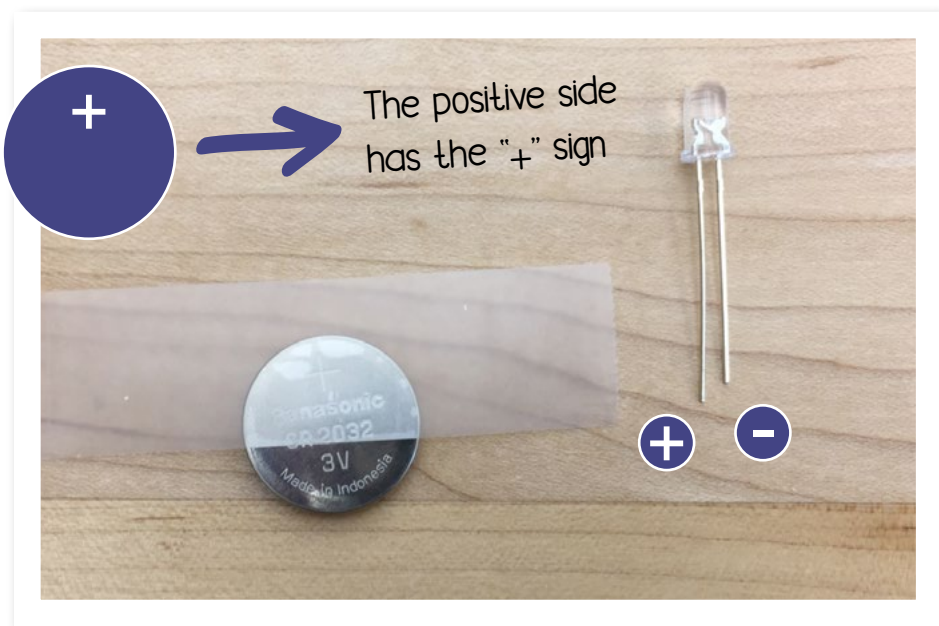

## Step 1:

Take a piece of tape and stick it across the positive side of the battery. Cover 2/3 of the battery.

### Step 2:

Take the long leg of the LED and puncture the tape, bring the leg down over the positive side of the battery.

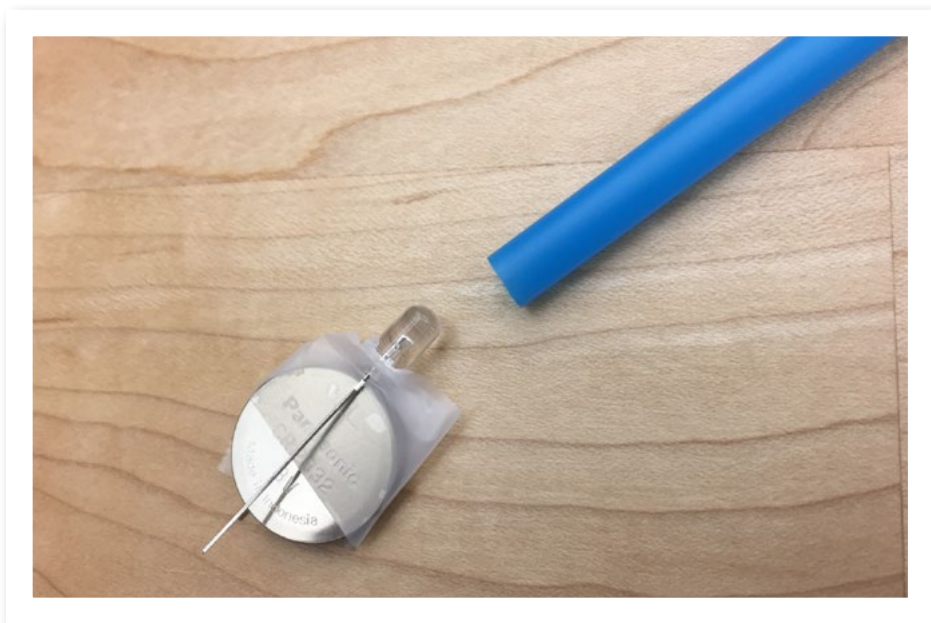
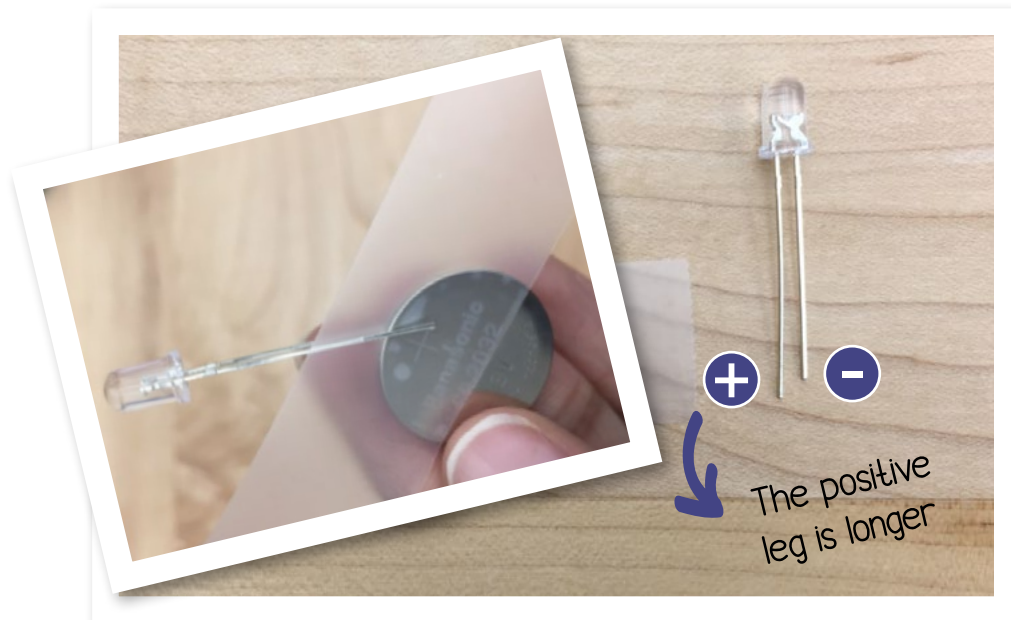

### Step 3:

After pushing the LED down, wrap the remaining tape around the battery. Put the LED in the straw.



### Step 4:

Tape the straw at the base, connecting LED/battery.

**Step 5:**

Pinch the LED legs together over the battery to turn on the LED.

**All done!**

